

March 2023

myHome User Guide—iOS

Rev 2 En



With our HCS Humidex® and myHome units you can manage the level of humidity in your home more accurately, at any time, from anywhere.

You are in control with the touch of a button or the touch of a screen!



gives you 24/7
unlimited access to:

- settings and controls
- real-time unit conditions
- local weather
- unit registration
- sign up and login

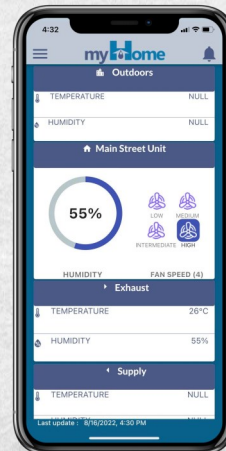

AVAILABLE FOR:



ClairiTech
INNOVATIONS

advanced clean air technology
technologie avancée de l'air pur



V2

The myHome App allows you to adjust settings and controls, monitor unit conditions in real time, check the weather forecast, and fill out the warranty card.

How to Download:

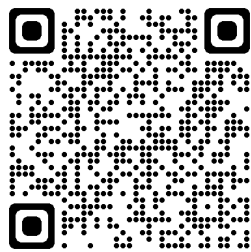

Scan the QR Code.



~ OR ~

Open the App Store

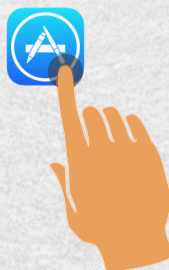

Search for
"Clairitech MyHome V2"

Tap the download/get
icon

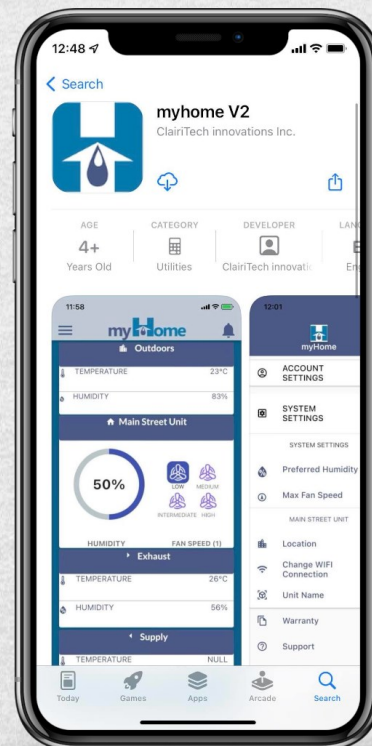

ClairiTech
INNOVATIONS

advanced clean air technology
technologie avancée de l'air pur

Signing in by Creating A New Account:

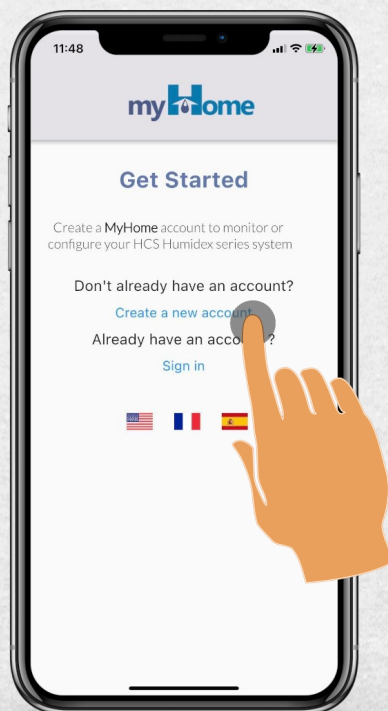

Step 1:
Tap
“Create a new account”

Step 2:
Fill in your email address
and password.

Tap “Create Account”

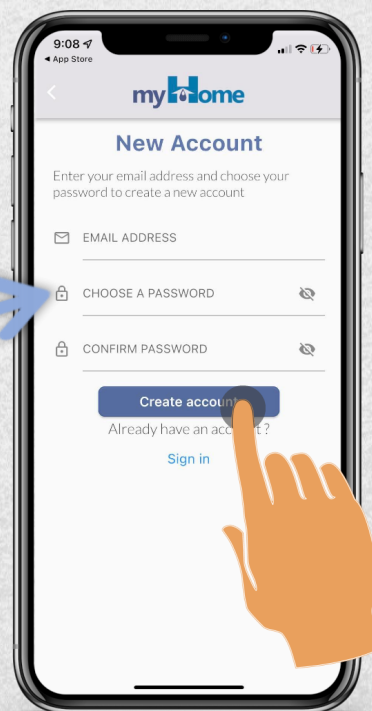

Signing in by Creating A New Account:

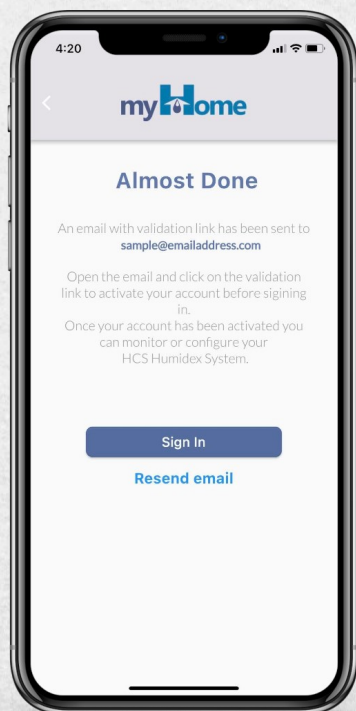

Step 3:

An email will be sent to verify your email address.

Step 4:

Check your email inbox or spam.
Click on (or tap) the link to verify your email address.

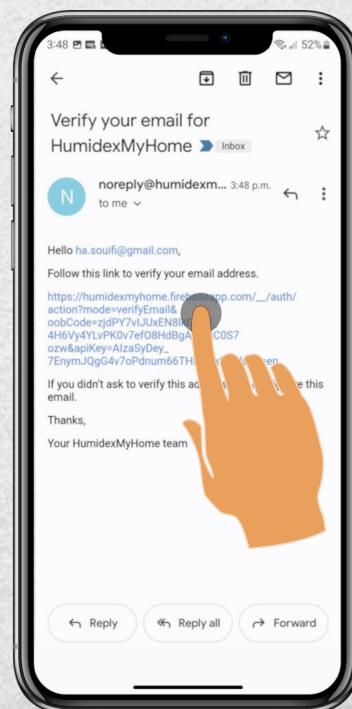

ClairiTech
INNOVATIONS

advanced clean air technology
technologie avancée de l'air pur

Signing in by Creating A New Account:

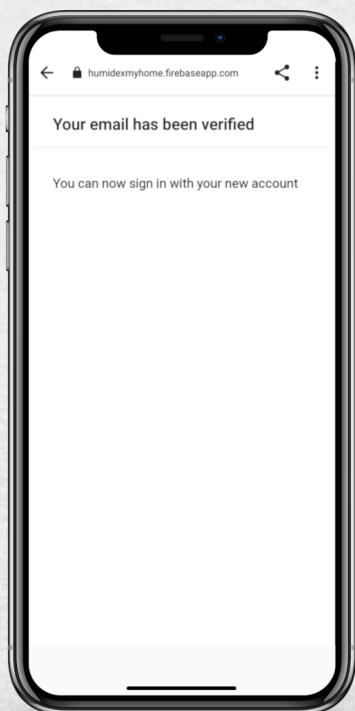

Step 5:

The validation process is complete.

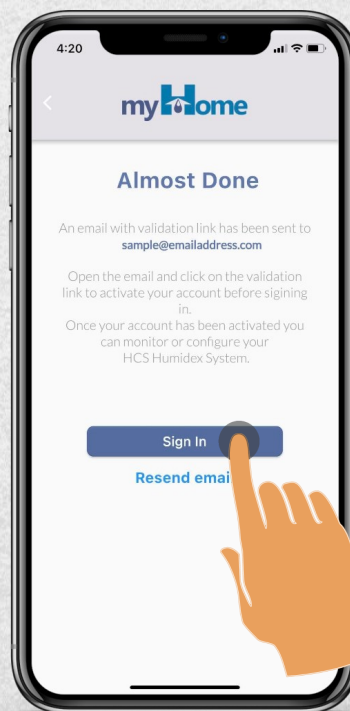

Step 6:

Tap "Sign In"

ClairiTech

INNOVATIONS

advanced clean air technology
technologie avancée de l'air pur

Signing in by Creating a New Account:

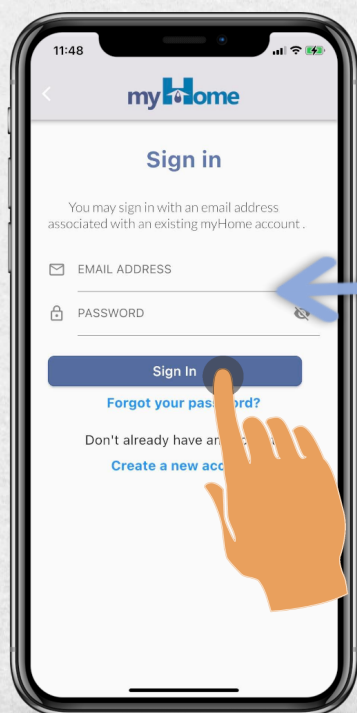

Step 7:

Enter your email address
and password.

Tap “Sign In”

ClairiTech

INNOVATIONS

advanced clean air technology
technologie avancée de l'air pur



How to Reset Your Password:

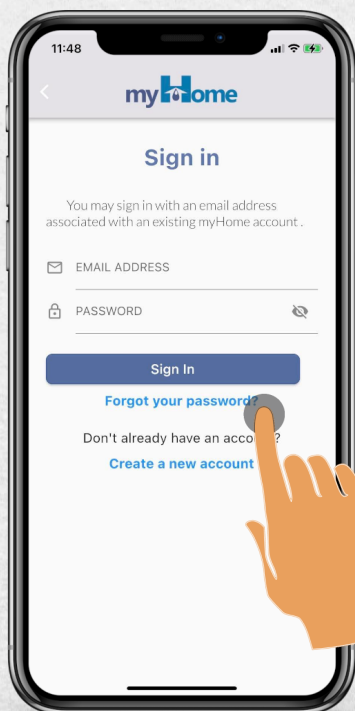

Step 1:

Tap “Forgot your password?”

Step 2:

Enter your email address.

Tap “Reset password”

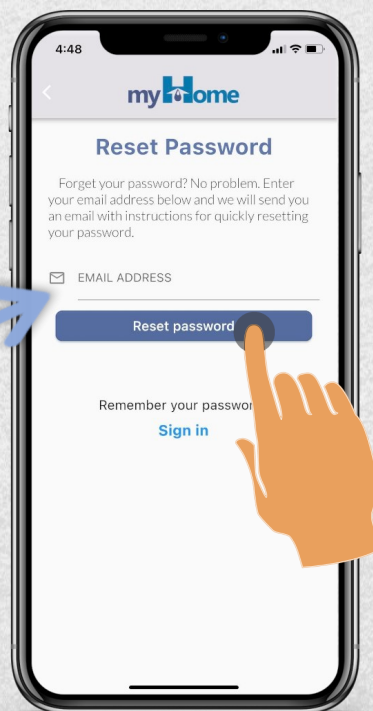

ClairiTech

INNOVATIONS

advanced clean air technology
technologie avancée de l'air pur

How to Reset Your Password:

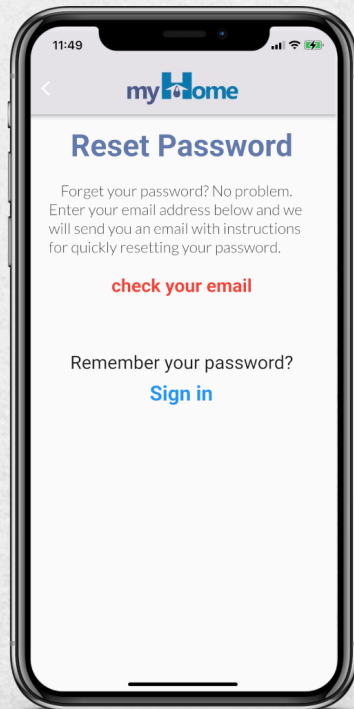

Step 3:

An email will be sent to reset your password.

Step 4:

Check your email's inbox or spam.

Click the link to reset your password.

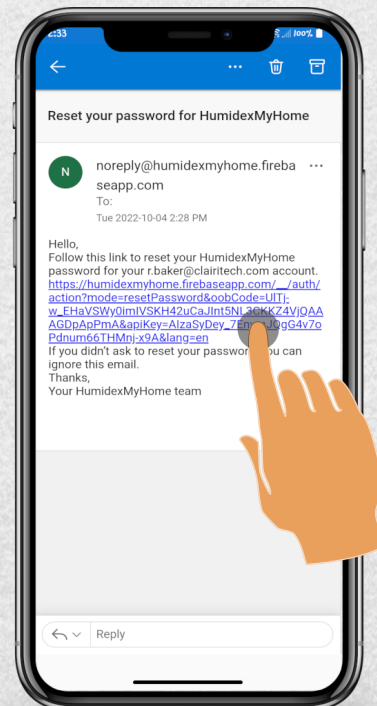

ClairiTech

INNOVATIONS

advanced clean air technology
technologie avancée de l'air pur

How to Reset Your Password:

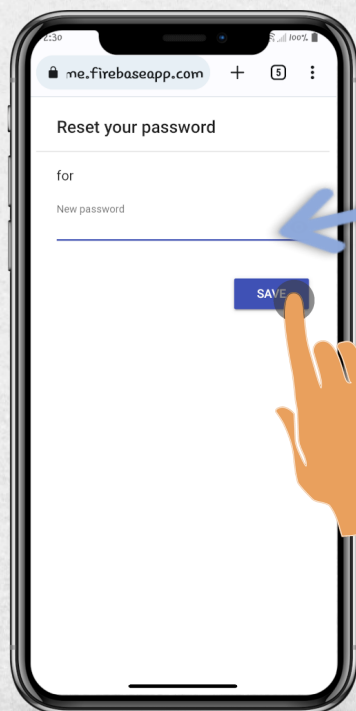

Step 5:

Enter your new password.

Tap "SAVE"

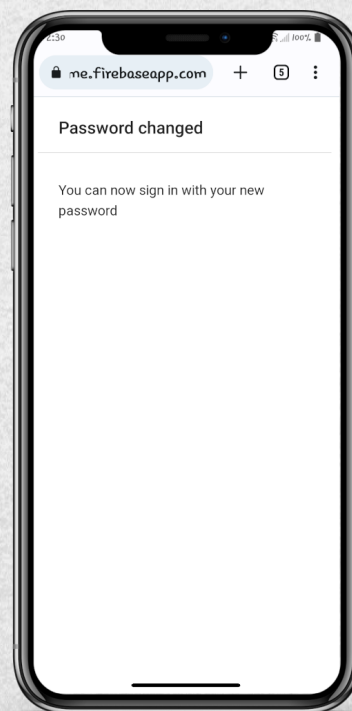

Step 6:

The reset password process is completed.

ClairiTech

INNOVATIONS

advanced clean air technology
technologie avancée de l'air pur

How to Reset Your Password:

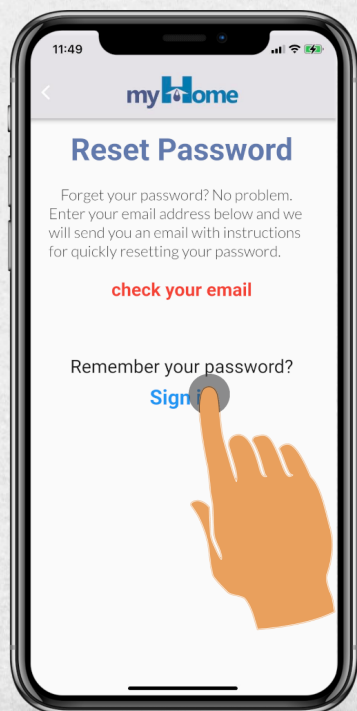

Step 7:
Tap “Sign in”

Step 8:
Enter your email address and
your new password.

Tap “Sign In”

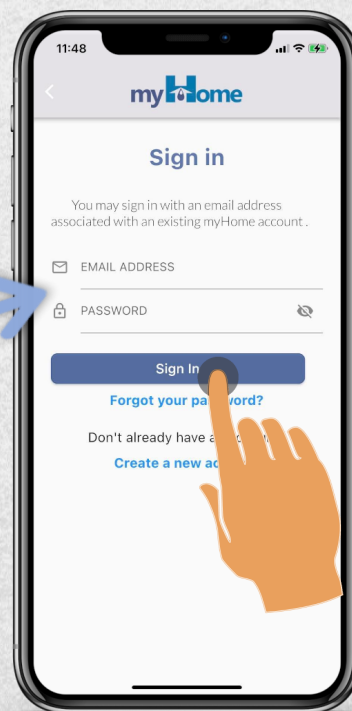

ClairiTech
INNOVATIONS

advanced clean air technology
technologie avancée de l'air pur

How to Add Your System

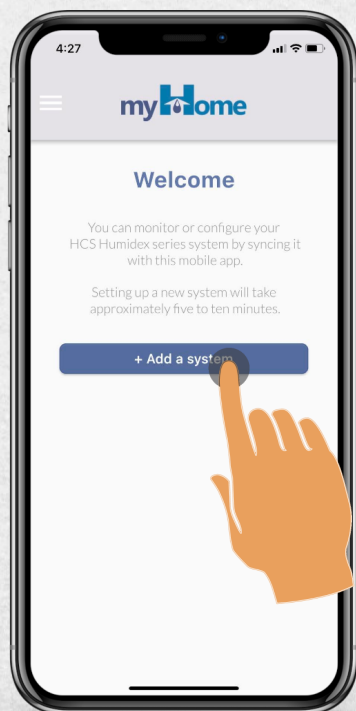

Step 1:
Tap “Add a system”

Step 2:
This screen outlines the
steps to add your system.

Tap “Continue”

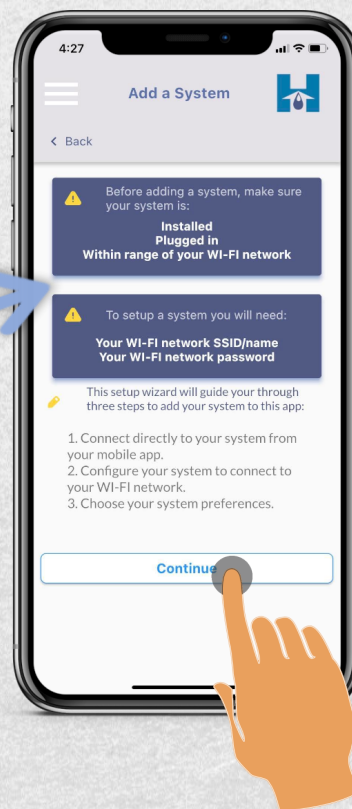

ClairiTech
INNOVATIONS

advanced clean air technology
technologie avancée de l'air pur

How to Add Your System

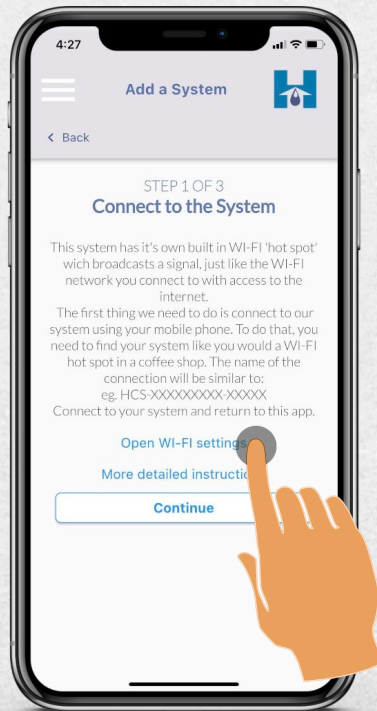

Step 3:

Tap “Open Wi-Fi settings”

Step 4:

The exhaust unit generally shows up under OTHER NETWORKS as “HCS-MYHOME-EXHAUST...”

Tap “HCS-MYHOME-EXHAUST...”

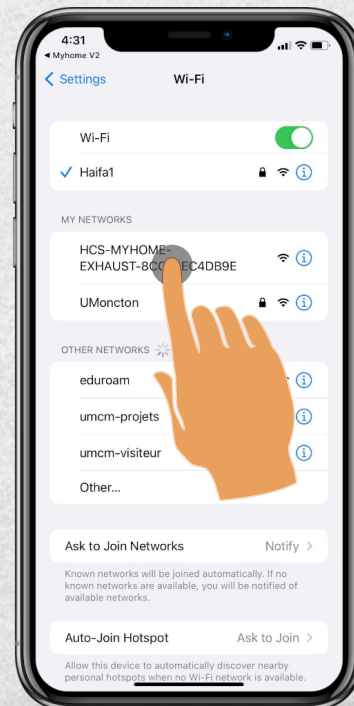

ClairiTech

INNOVATIONS

advanced clean air technology
technologie avancée de l'air pur

How to Add Your System

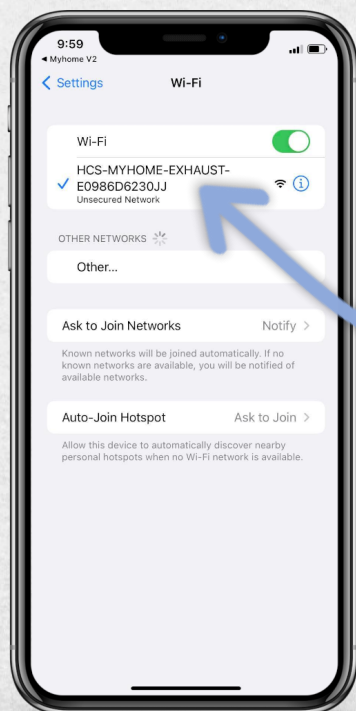

Step 5:

After connecting to the HCS-MYHOME-EXHAUST... network, return to the previous screen.

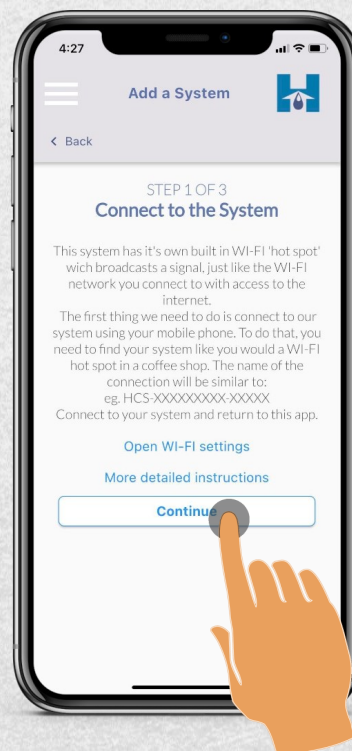

Step 6:

Tap “Continue”

ClairiTech
INNOVATIONS

advanced clean air technology
technologie avancée de l'air pur

How to Add Your System

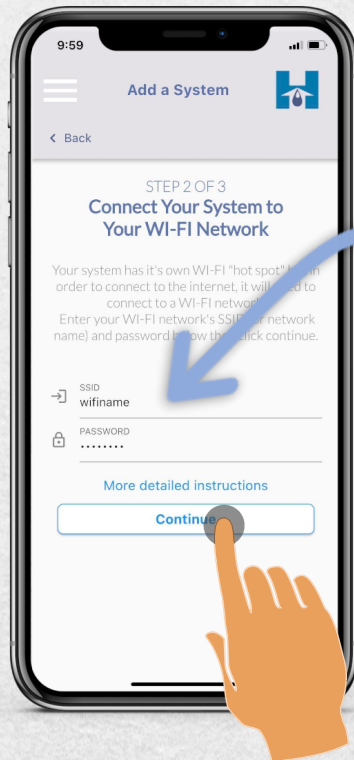

Step 7:
Enter your WiFi SSID and password.

Tap “Continue”

Step 8:
Wait while the system
is being added.

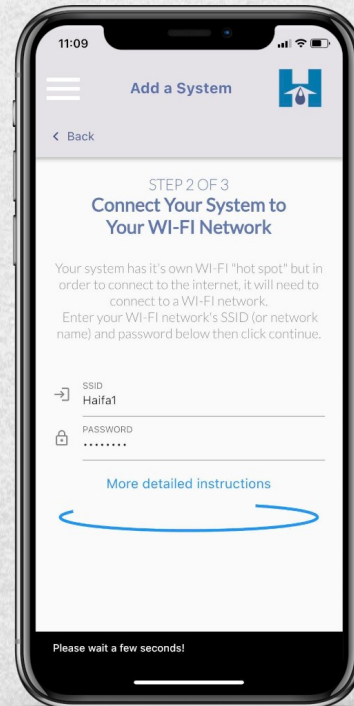

ClairiTech

INNOVATIONS

advanced clean air technology
technologie avancée de l'air pur



How to Add Your System

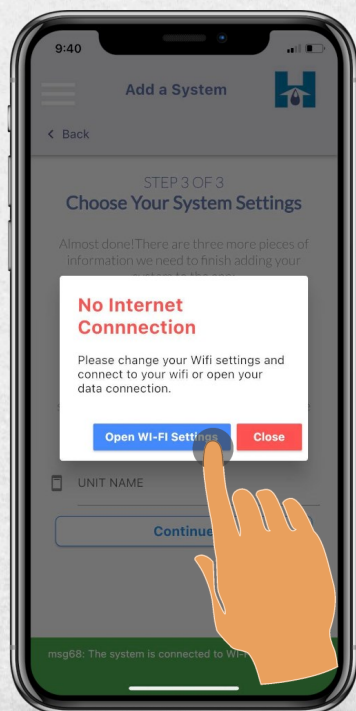

Step 9:

Tap “Open Wi-Fi Settings”

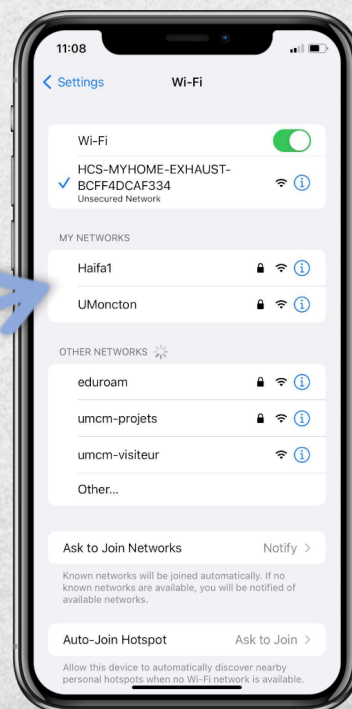

Step 10:

Tap your Wi-Fi SSID

Return to the previous screen.

ClairiTech

INNOVATIONS

advanced clean air technology
technologie avancée de l'air pur

How to Add Your System

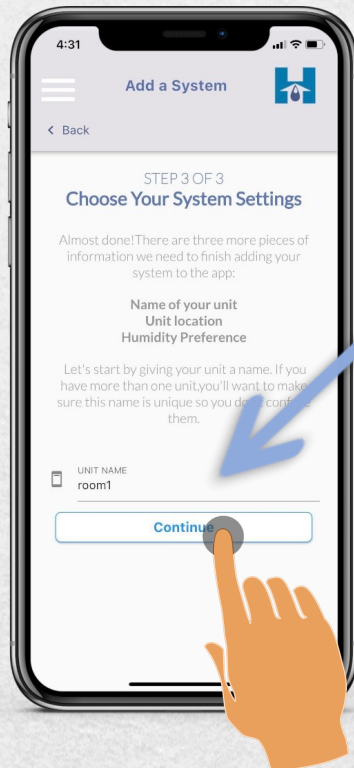

Step 11:

You may enter a name for your Humidex.

Tap "Continue"

Step 12:

Unit Name successfully changed.

You may select your country.

Tap "Continue"

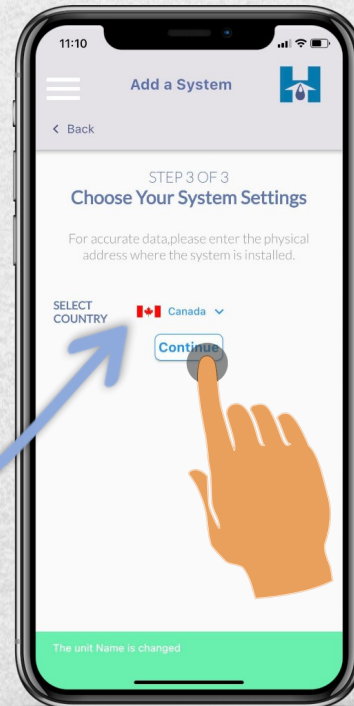

ClairiTech

INNOVATIONS

advanced clean air technology
technologie avancée de l'air pur

How to Add Your System

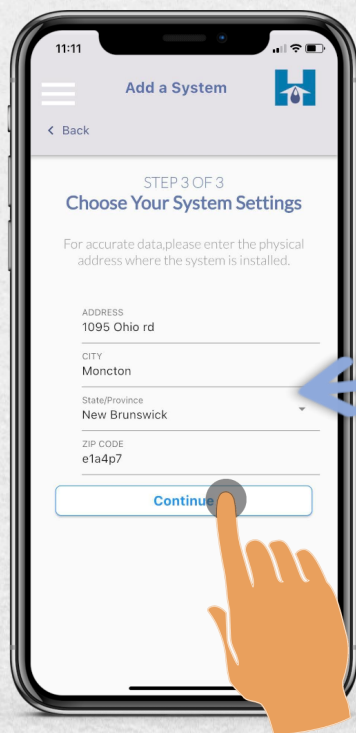

Step 13:
Enter your address.

Tap “Continue”

Step 14:
Your address updated successfully.

You may select your
preferred Humidity.

Tap “Continue”

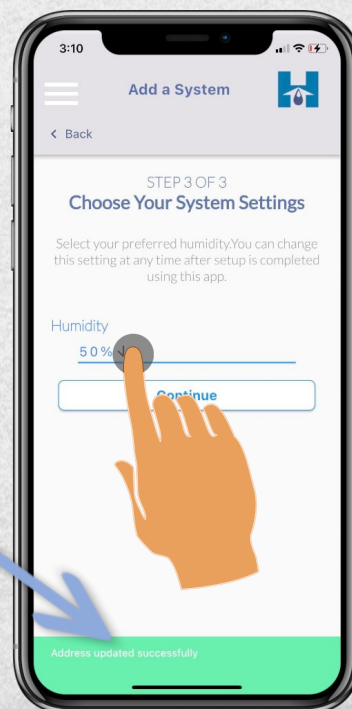

ClairiTech
INNOVATIONS

advanced clean air technology
technologie avancée de l'air pur

How to Add Your System

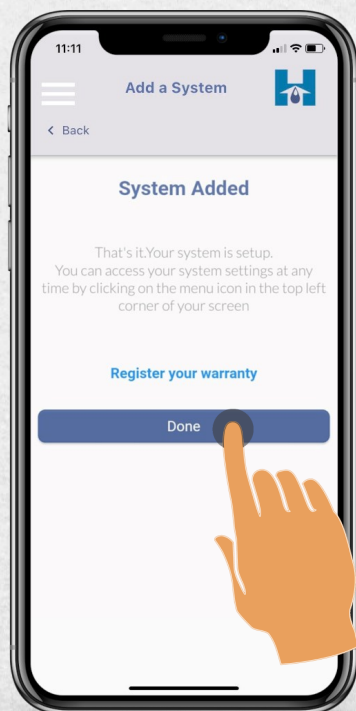

Step 15:
Tap "Done"

Your Humidex is syncing with
the myHome App.

Please wait.



ClairiTech

INNOVATIONS

advanced clean air technology
technologie avancée de l'air pur



How to Add Your System

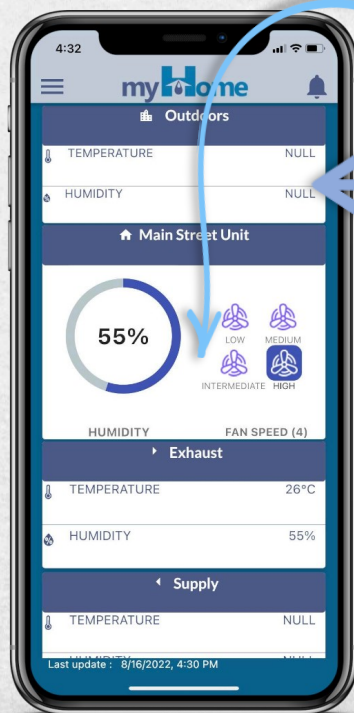

System data will be displayed on the dashboard screen.

After 30 minutes from the last update, new Humidex data will be displayed, and the outdoors temperature and humidity will be displayed.

Swipe down to refresh the dashboard.

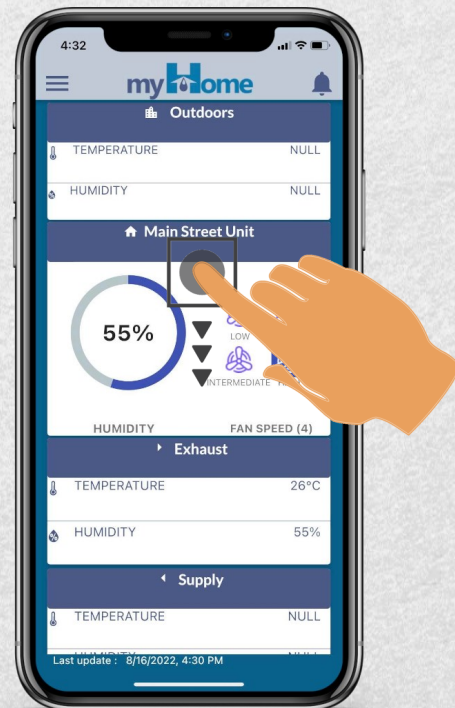

ClairiTech

INNOVATIONS

advanced clean air technology
technologie avancée de l'air pur

How to Add Your System Using the Menu

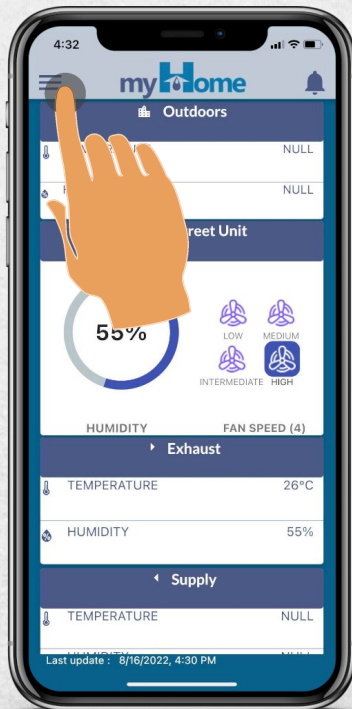

Step 1:
Tap the menu icon.

Step 2:
Tap “Add New System”
Follow the steps for
[How to Add Your System](#)

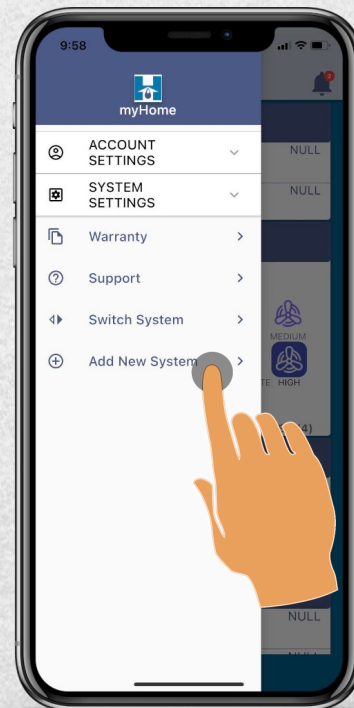

How to Change Your Preferred Humidity



Step 1:
Tap the circle.

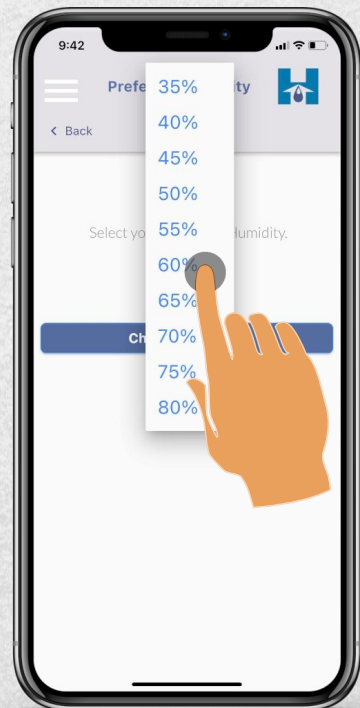

Step 2:
Select your preferred Humidity.

How to Change Your Preferred Humidity

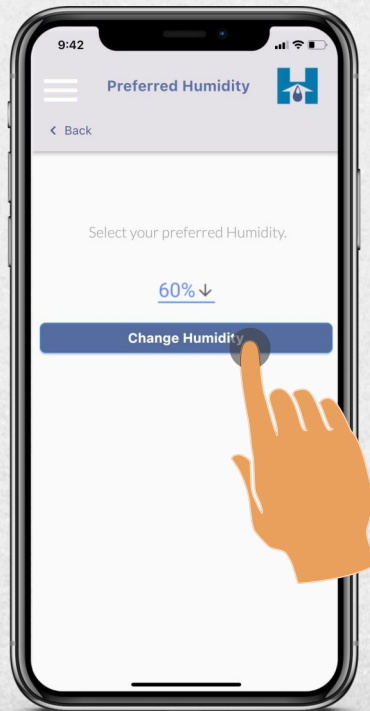

Step 3:

Once your preferred Humidity is selected,

Tap “Change Humidity”

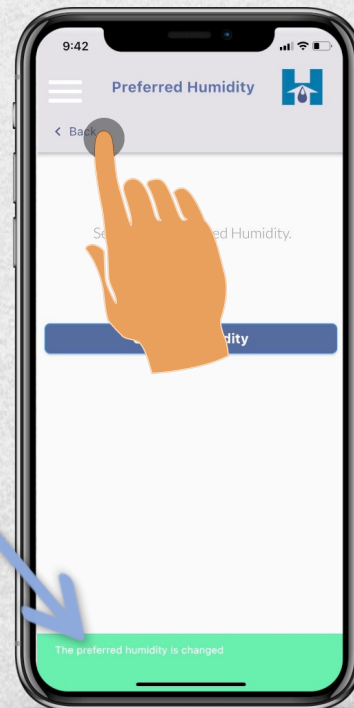

Step 4:

Your preferred humidity is successfully set.

Tap “Back”

ClairiTech

INNOVATIONS

advanced clean air technology
technologie avancée de l'air pur

How to Change Preferred Humidity Using the Menu

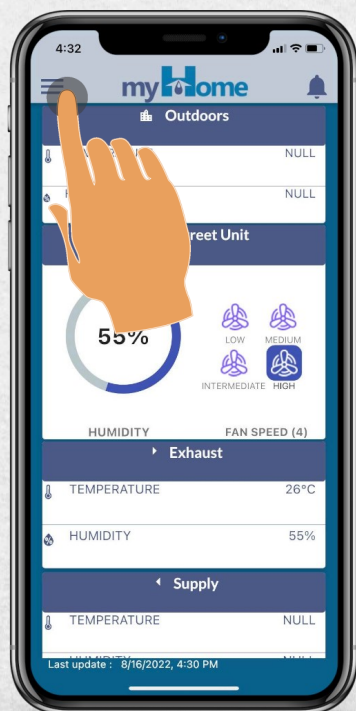

Step 1:
Tap the menu icon.

Step 2:
Tap “System Settings”

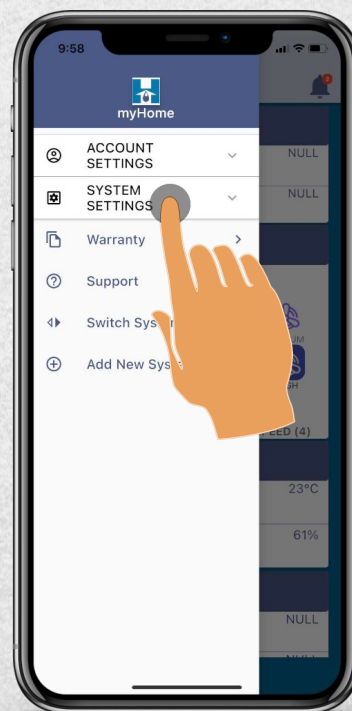

ClairiTech
INNOVATIONS

advanced clean air technology
technologie avancée de l'air pur

How to Change Preferred Humidity Using the Menu

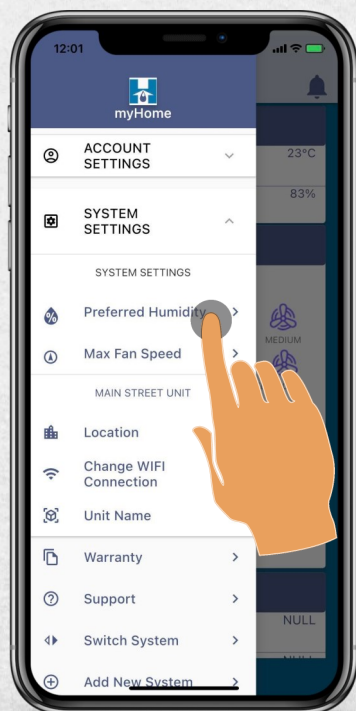

Step 3:
Tap “Preferred Humidity”

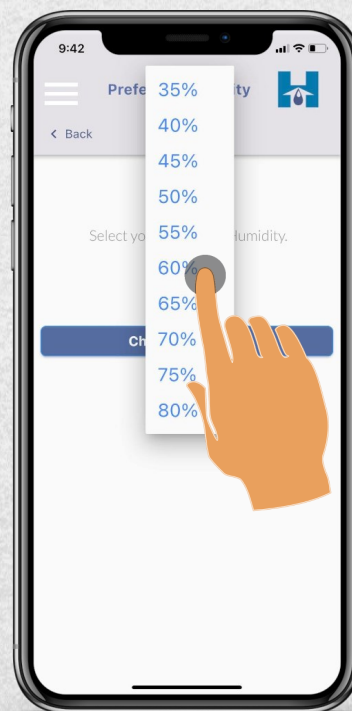

Step 4:
Select your preferred Humidity.

ClairiTech

INNOVATIONS

advanced clean air technology
technologie avancée de l'air pur



How to Change Preferred Humidity Using the Menu

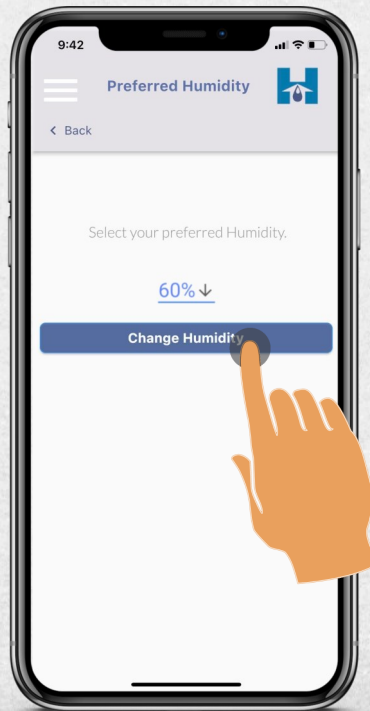

Step 5:

Once your preferred Humidity is selected,

Tap “Change Humidity”

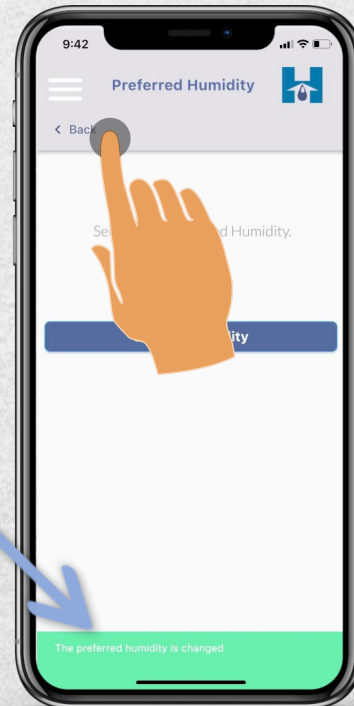

Step 6:

Your preferred humidity is successfully set.

Tap “Done”

ClairiTech

INNOVATIONS

advanced clean air technology
technologie avancée de l'air pur

How to Change The maximum (max) fan speed:

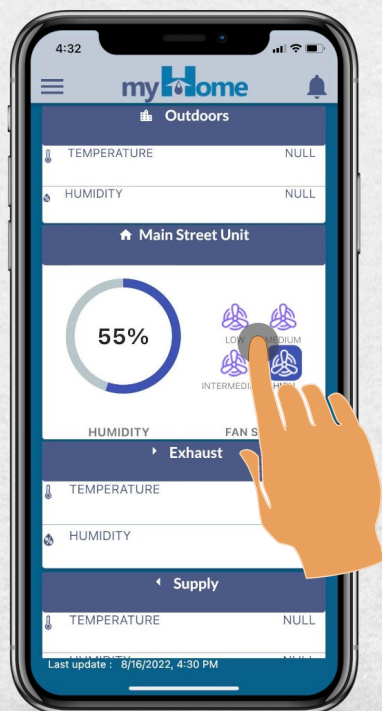

Step 1:
Tap the fans

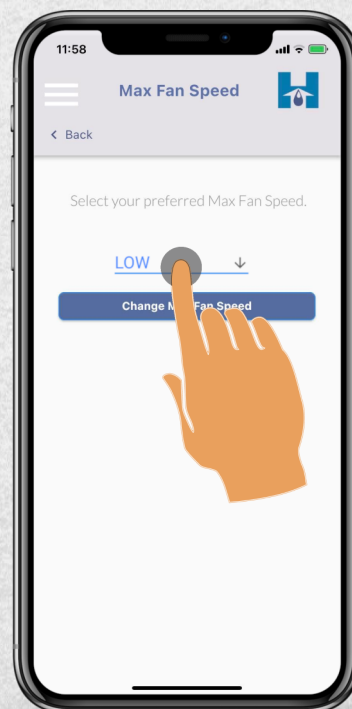

Step 2:
Tap "LOW"

ClairiTech

INNOVATIONS

advanced clean air technology
technologie avancée de l'air pur

How to Change The maximum (max) fan speed:

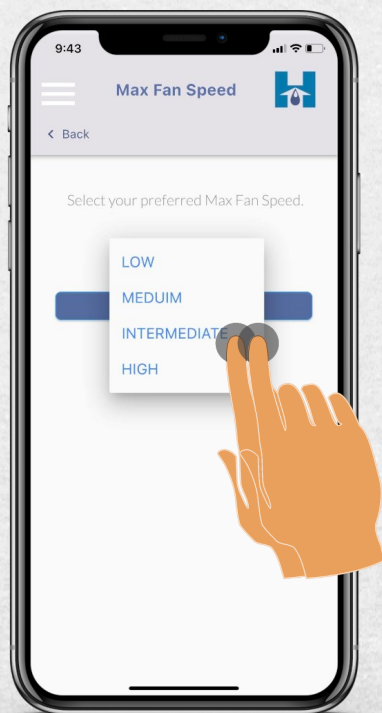

Step 3:
Tap the desired speed

Step 4:
Once the preferred
Max Fan Speed is selected
Tap “Change Max Fan Speed”
The Max Fan Speed is changed.

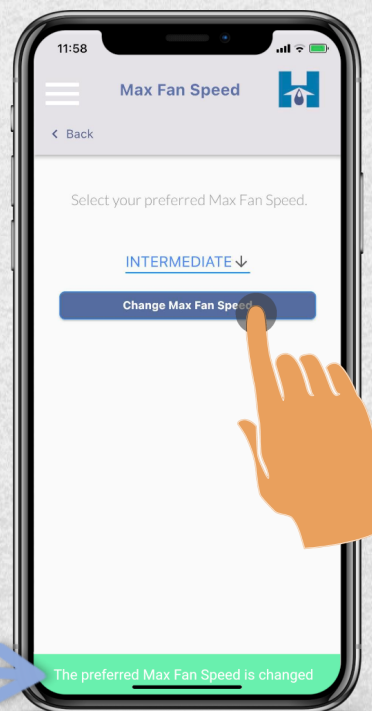

How to Change the Max Fan Speed using the menu:

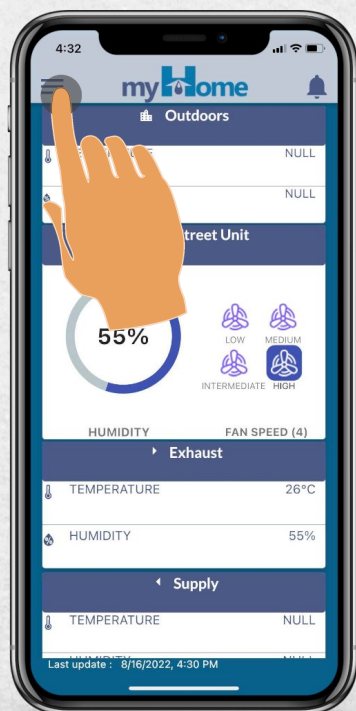

Step 1:
Tap the menu icon

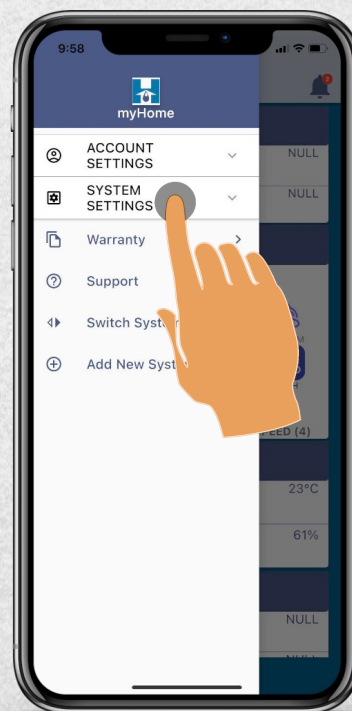

Step 2:
Tap “SYSTEM SETTINGS”

ClairiTech

INNOVATIONS

advanced clean air technology
technologie avancée de l'air pur

How to Change the Max Fan Speed using the menu:

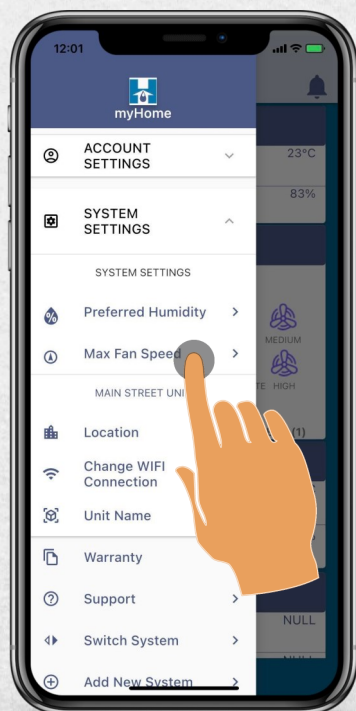

Step 3:
Tap “Max Fan Speed”

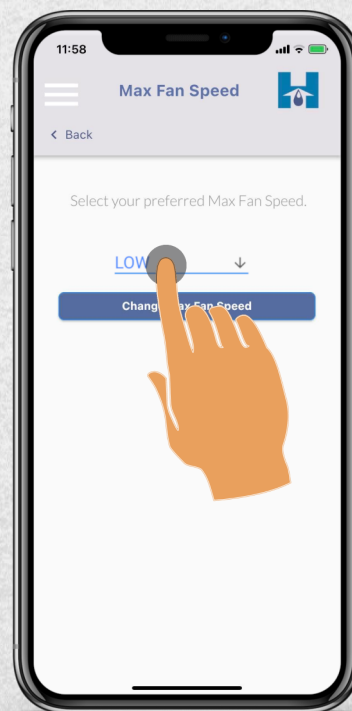

Step 4:
Tap “LOW”
to see the fan speed options

How to Change the Max Fan Speed using the menu:

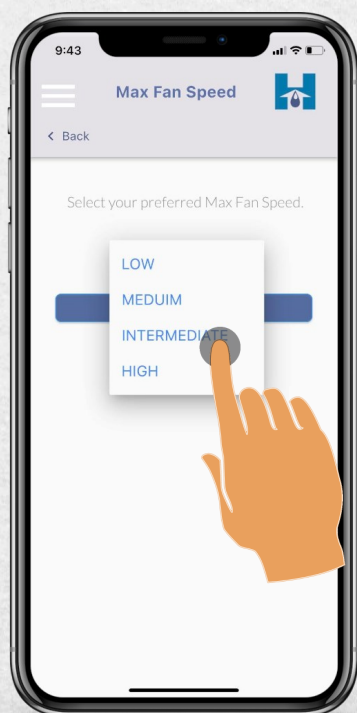

Step 5:
Tap the desired speed

Step 6:
Once your preferred
Max Fan Speed is selected
Tap "Change Max Fan Speed"
The Max Fan Speed is changed.



How to Change Your Password Using the Menu:

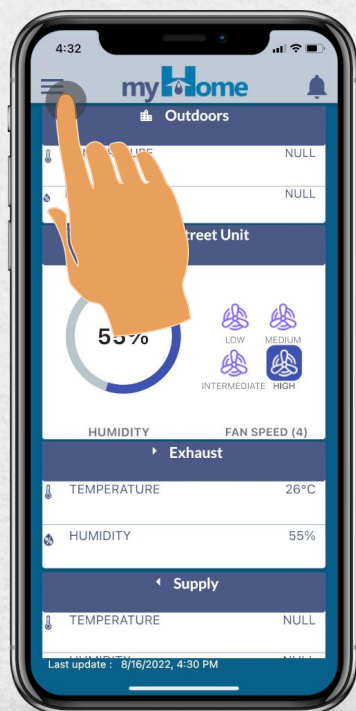

Step 1:
Tap the menu icon

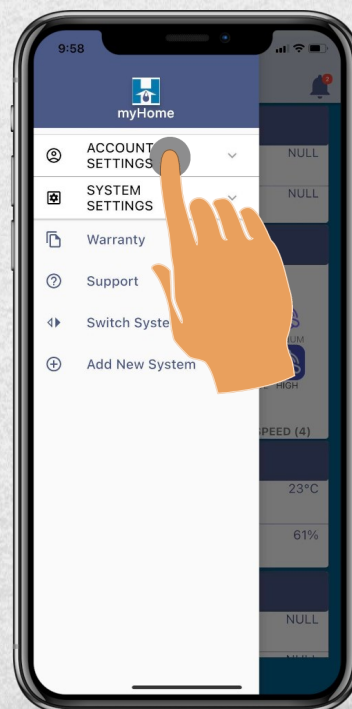

Step 2:
Tap “ACCOUNT SETTINGS”

ClairiTech

INNOVATIONS

advanced clean air technology
technologie avancée de l'air pur

How to Change Your Password Using the Menu:

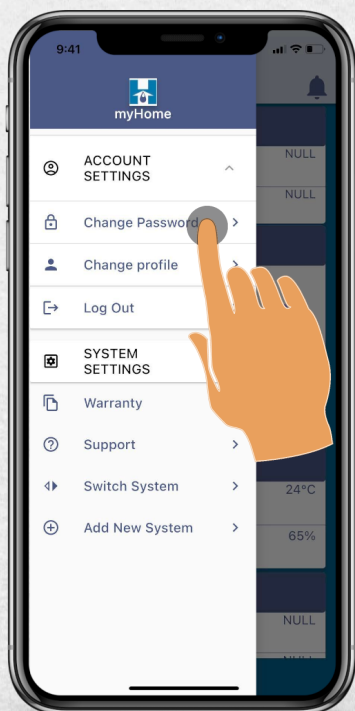

Step 3:
Tap “Change Password”

Step 4:
Enter your new password.

Tap “Change Password”

Your password has been changed.

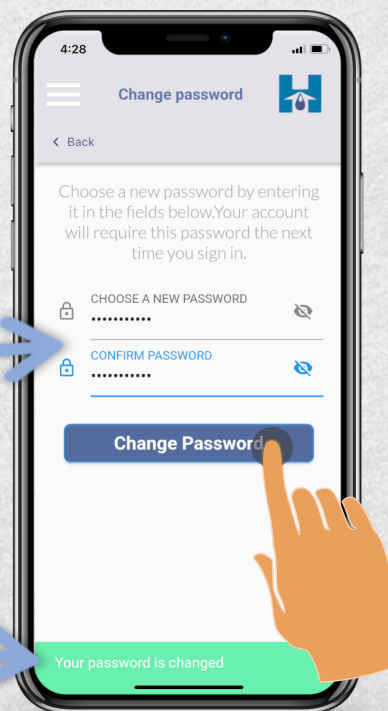

How to Add or Update Your Personal Information:

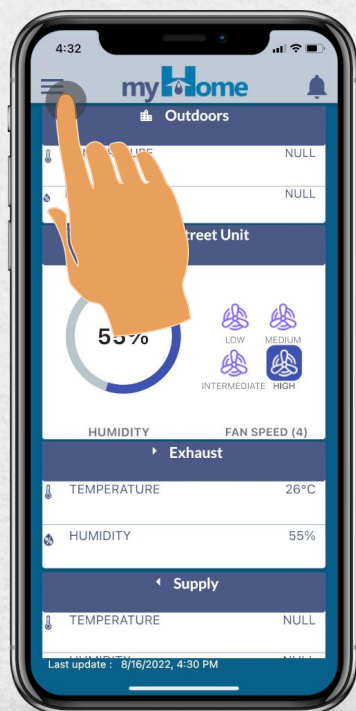

Step 1:
Tap the menu icon

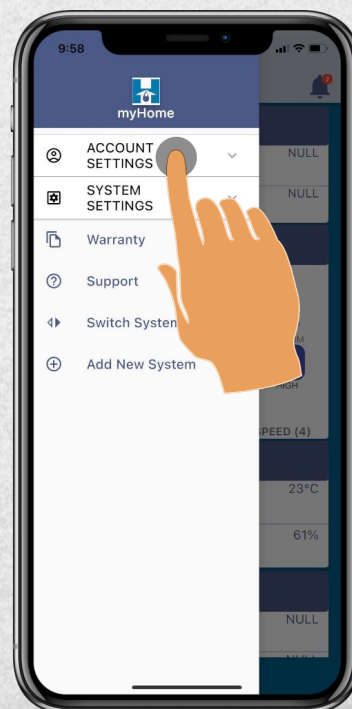

Step 2:
Tap “ACCOUNT SETTINGS”

ClairiTech
INNOVATIONS

advanced clean air technology
technologie avancée de l'air pur

How to Add or Update Your Personal Information:

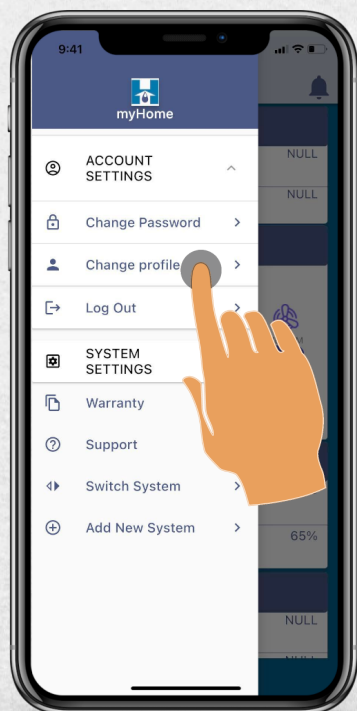

Step 3:
Tap “Change Profile”

Step 4:
Enter your personal information.
Tap “update profile”

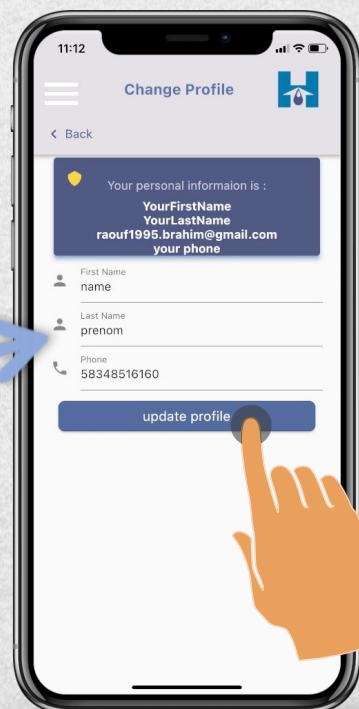



How to Log Out From the App:

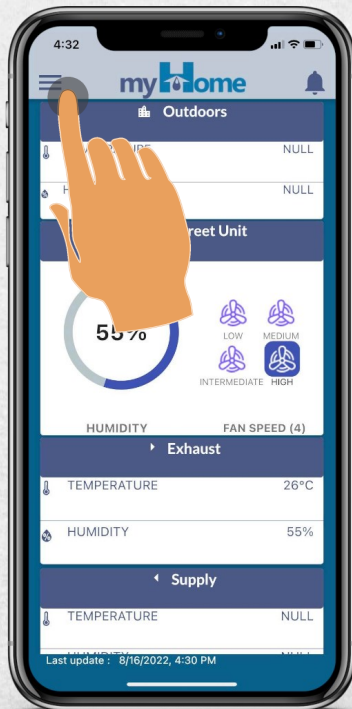

Step 1:

Tap the menu icon

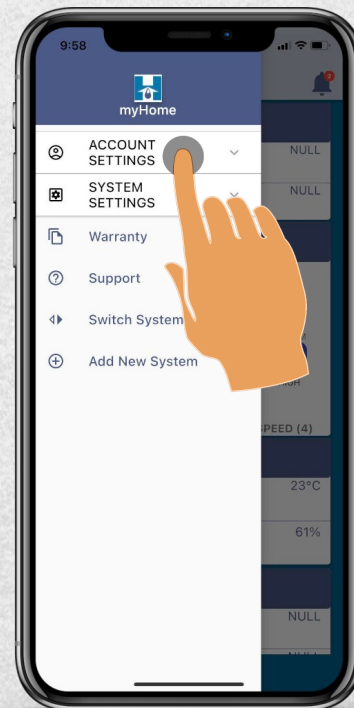

Step 2:

Tap “ACCOUNT SETTINGS”

ClairiTech

INNOVATIONS

advanced clean air technology
technologie avancée de l'air pur

How to Log Out From the App:

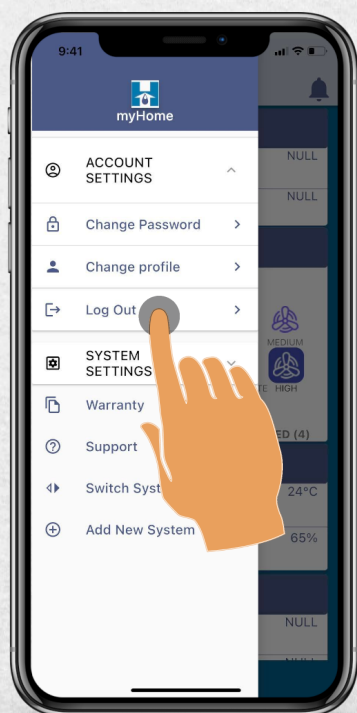

Step 3:
Tap “Log Out”

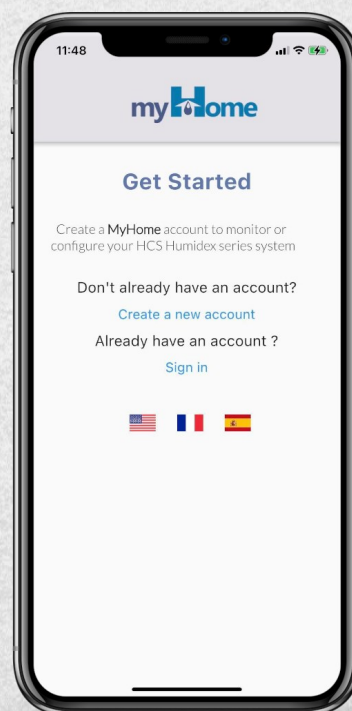

Step 4:
You have successfully
Logged Out.

ClairiTech

INNOVATIONS

advanced clean air technology
technologie avancée de l'air pur

How to Change Your System Location:

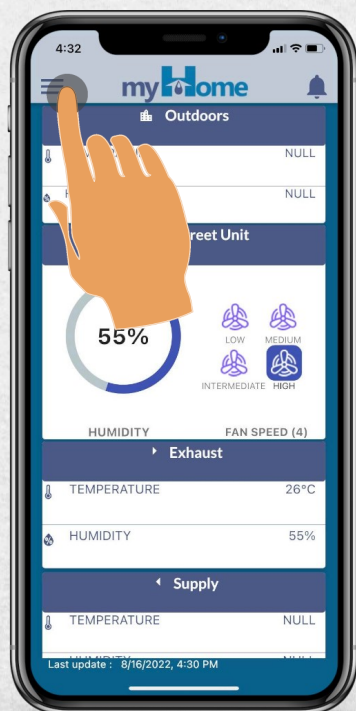

Step 1:
Tap the menu icon

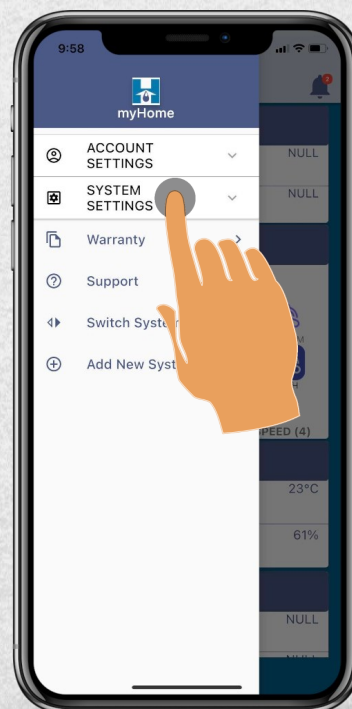

Step 2:
Tap “SYSTEM SETTINGS”

How to Change Your System Location:

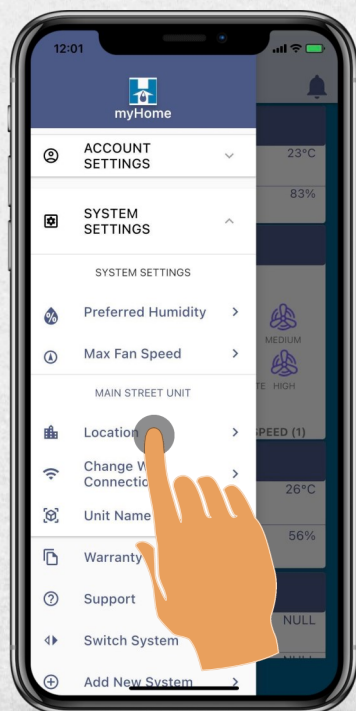

Step 3:
Tap “Location”

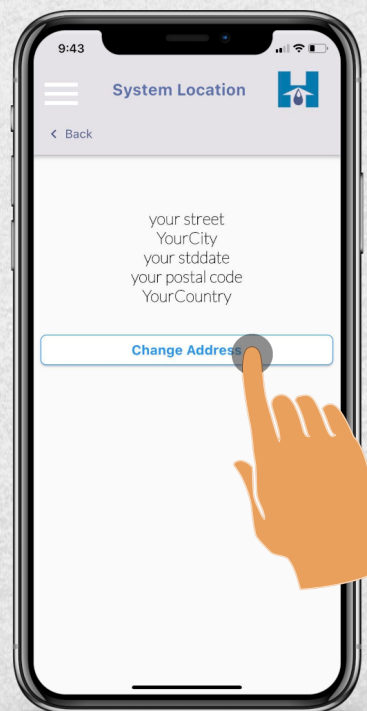

Step 4:
Tap “Change Address”

ClairiTech

INNOVATIONS

advanced clean air technology
technologie avancée de l'air pur

How to Change Your System Location:

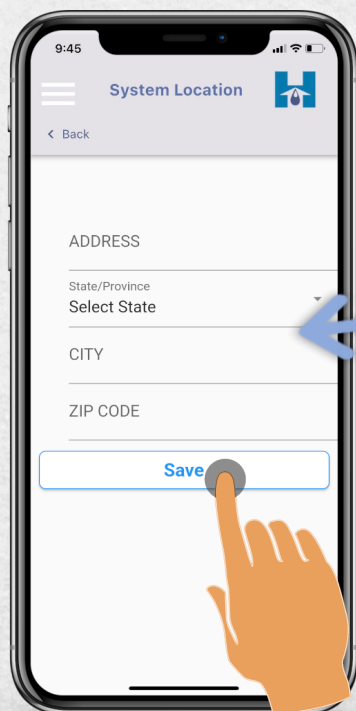

Step 5:

Enter the address where your system is located.

Tap “Save”

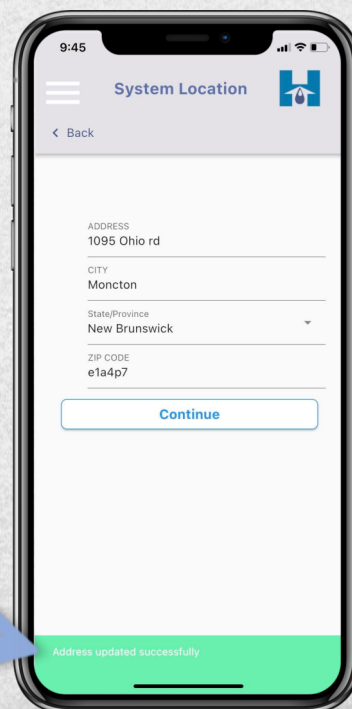

Step 6:

The address has been successfully updated.

ClairiTech

INNOVATIONS

advanced clean air technology
technologie avancée de l'air pur

How to Change Your System's Name:

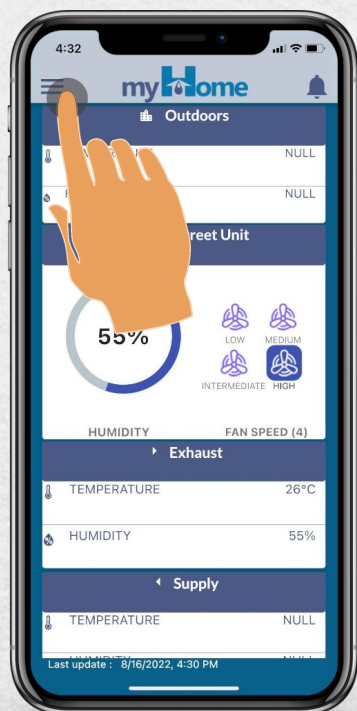

Step 1:
Tap the menu icon

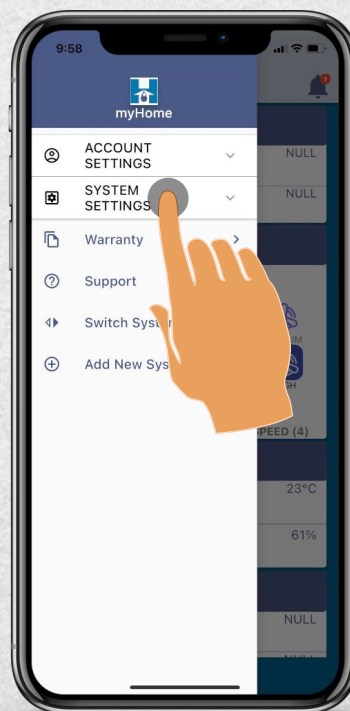

Step 2:
Tap "SYSTEM SETTINGS"

ClairiTech

INNOVATIONS

advanced clean air technology
technologie avancée de l'air pur



How to Change Your System's Name:

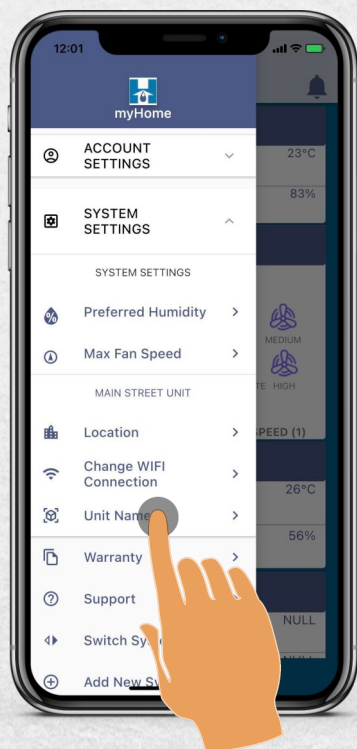

Step 3:

Tap "Unit Name"



Step 4:

Enter the new Unit's name.

Tap "Continue"

The Unit's name has been successfully changed.

ClairiTech

INNOVATIONS

advanced clean air technology
technologie avancée de l'air pur

How to Change Your Wi-Fi Connection:

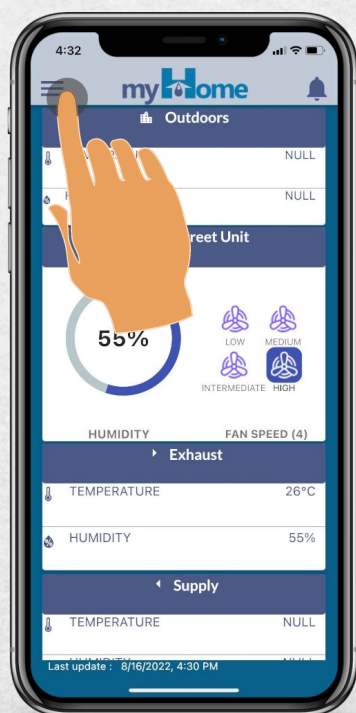

Step 1:
Tap the menu icon

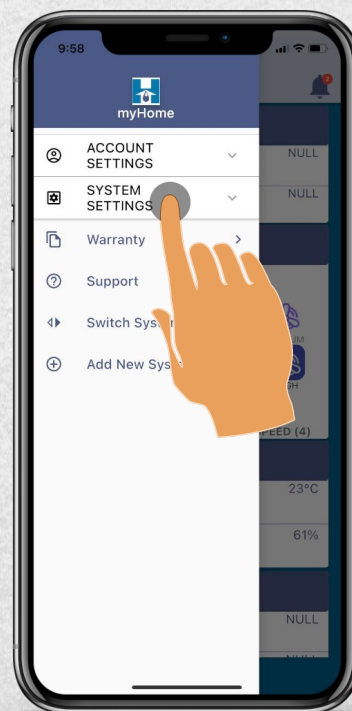

Step 2:
Tap “SYSTEM SETTINGS”

ClairiTech
INNOVATIONS

advanced clean air technology
technologie avancée de l'air pur



How to Change Your Wi-Fi Connection:

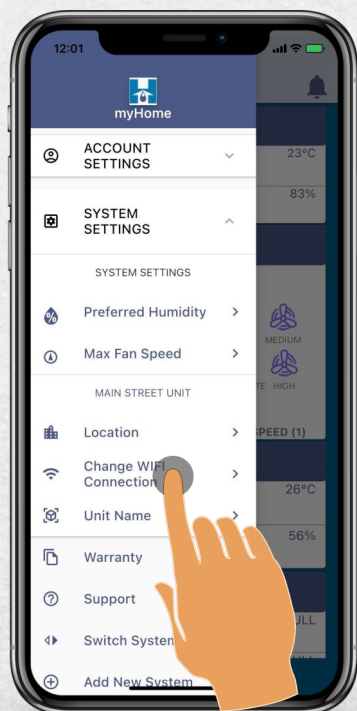

Step 3:

Tap “Change Wi-Fi Connection”

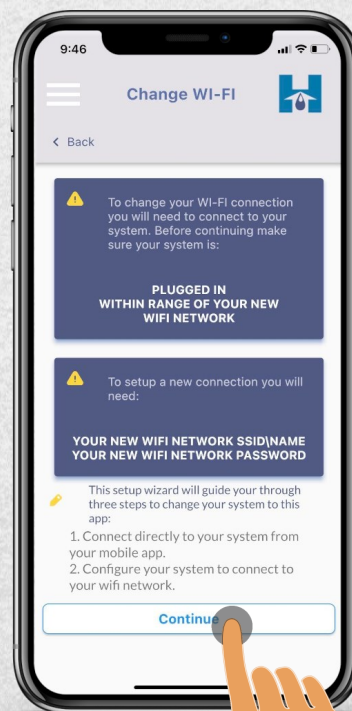

Step 4:

This screen outlines the upcoming steps.

Tap “Continue”

ClairiTech
INNOVATIONS

advanced clean air technology
technologie avancée de l'air pur

How to Change Your Wi-Fi Connection:

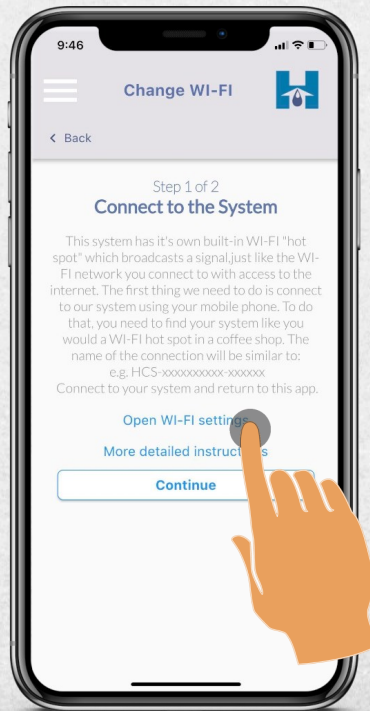

Step 5:

Tap “Open Wi-Fi settings”

Step 6:

The exhaust unit should show up here under OTHER NETWORKS as “HCS-MYHOME-EXHAUST...”

Tap “HCS-MYHOME-EXHAUST”

Return to the myHome App.

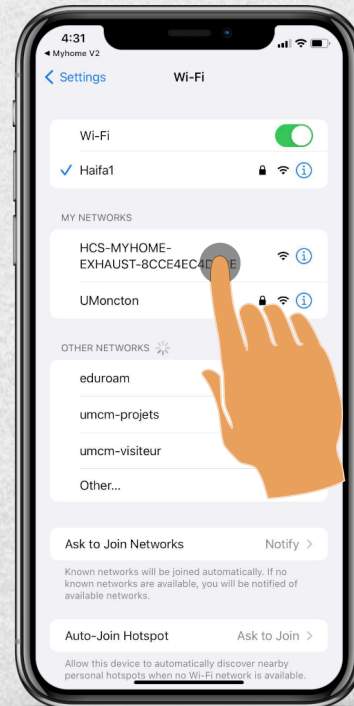

How to Change Your Wi-Fi Connection:

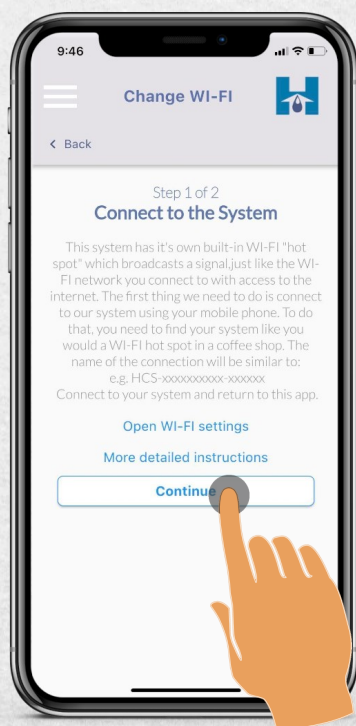

Step 7: Tap "Continue"

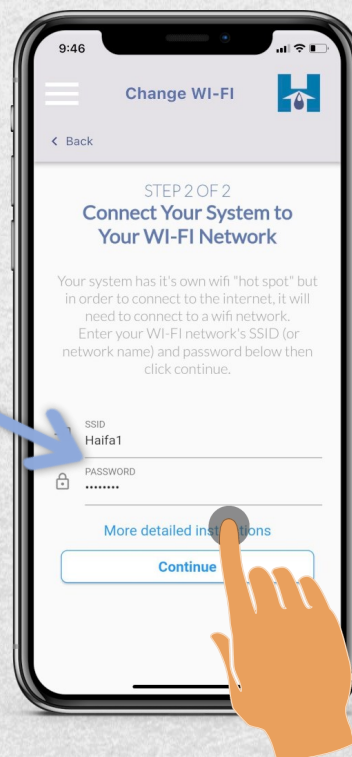

Step 8: Enter the new Wi-Fi network's SSID and password.

Tap "Continue"

ClairiTech
INNOVATIONS

advanced clean air technology
technologie avancée de l'air pur

How to Change Your Wi-Fi Connection:

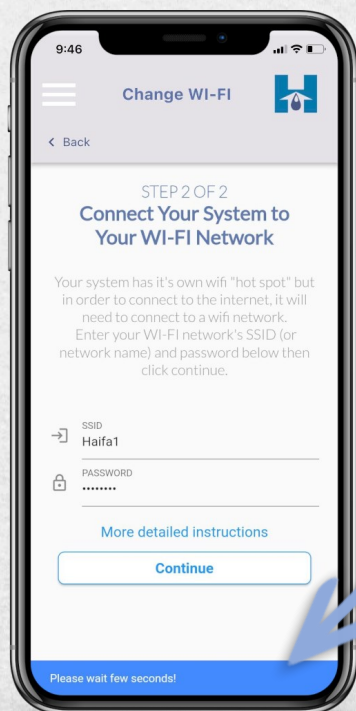

Step 9:

Wait while the system is being connected to the new Wi-Fi network.

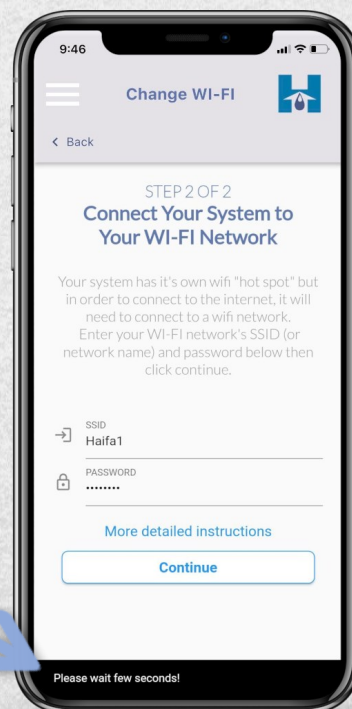

Step 10:

Please wait a moment longer.

ClairiTech

INNOVATIONS

advanced clean air technology
technologie avancée de l'air pur

How to Change Your Wi-Fi Connection:



Step 11:

The system is successfully connected to the new Wi-Fi network.

Tap “Done”

ClairiTech

INNOVATIONS

advanced clean air technology
technologie avancée de l'air pur

How to Register Your Unit:

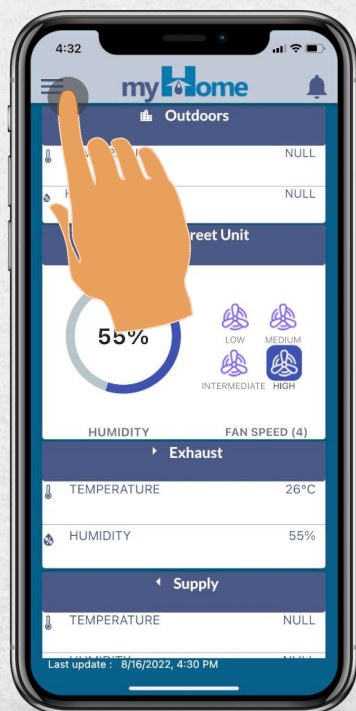

Step 1:
Tap the menu icon

Step 2:
Tap “Warranty”

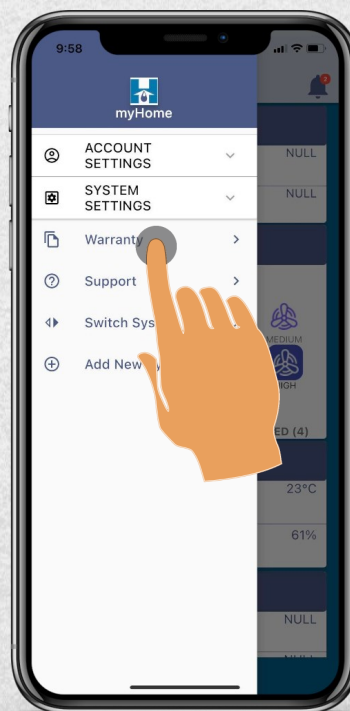

ClairiTech

INNOVATIONS

advanced clean air technology
technologie avancée de l'air pur

How to Register Your Unit:

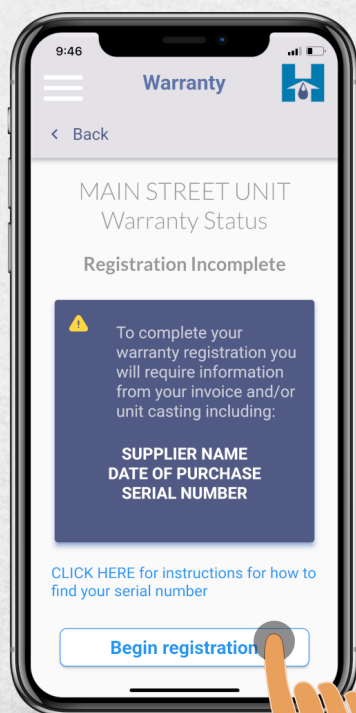

Step 3:
Tap “Begin Registration”

Step 4:
Enter the contact information
of the system’s owner.

Tap “Continue”

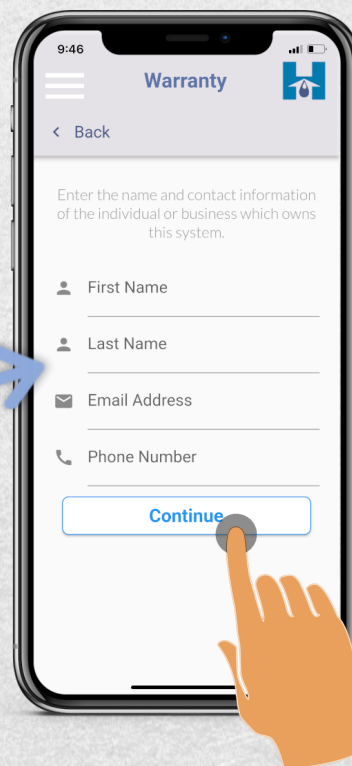

ClairiTech
INNOVATIONS

advanced clean air technology
technologie avancée de l'air pur

How to Register Your Unit:

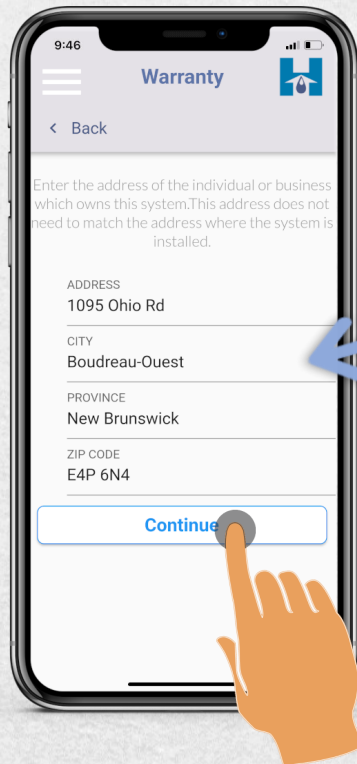

Step 5:
Enter the physical address
of the system's owner.

Tap "Continue"

Step 6:
Enter the required information.

Tap "Continue"

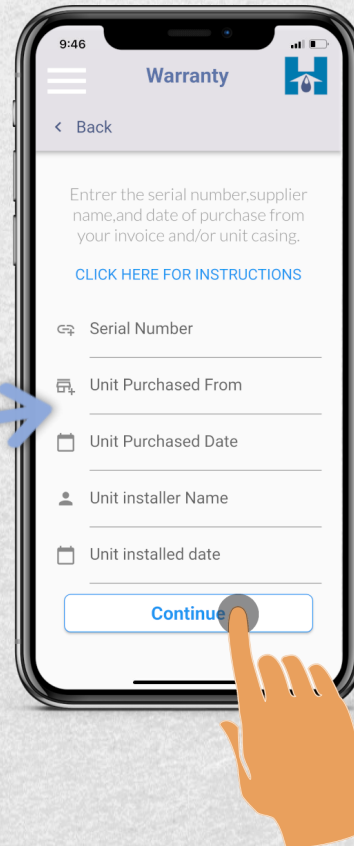

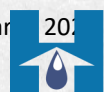

How to Register Your Unit:

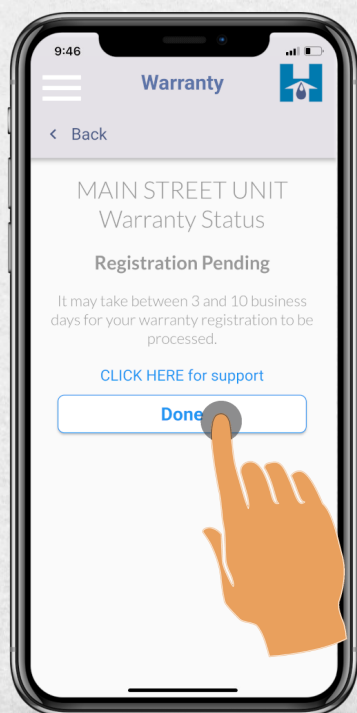

Step 7:
Tap “Done”

How to Choose Your Preferred Main Unit:

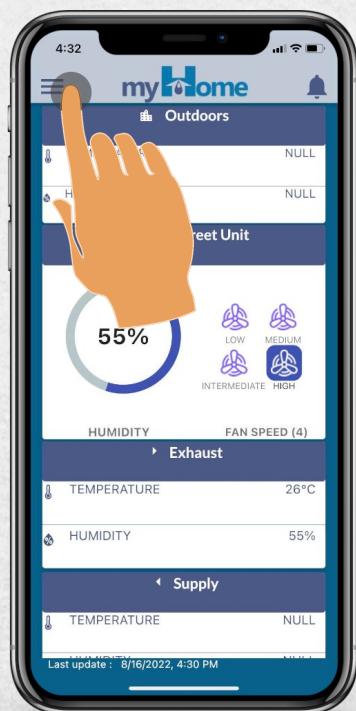

Step 1:
Tap the menu icon

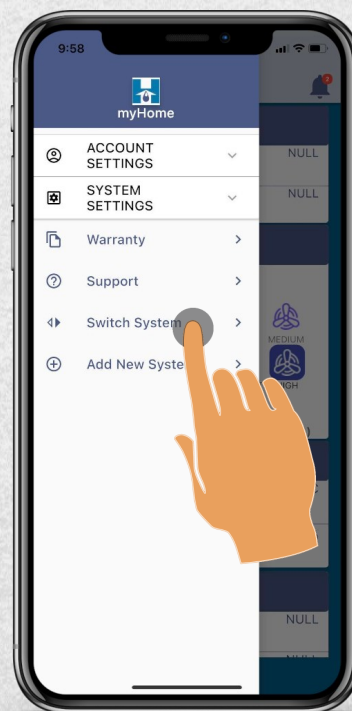

Step 2:
Tap “Switch System”

ClairiTech

INNOVATIONS

advanced clean air technology
technologie avancée de l'air pur



How to Choose Your Preferred Main Unit:

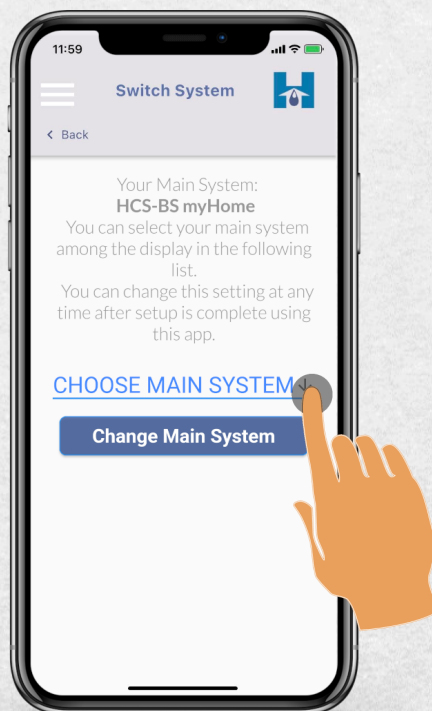

Step 3:

Tap “CHOOSE MAIN SYSTEM”

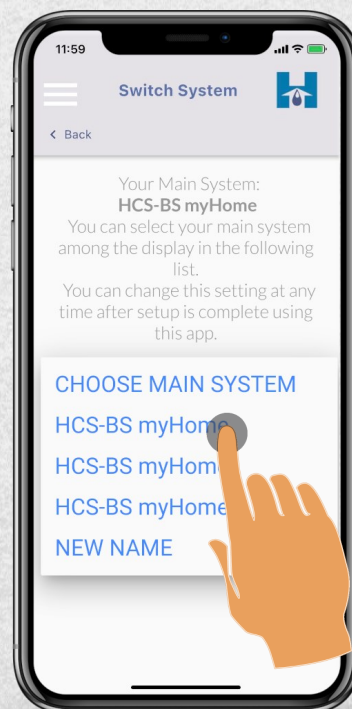

Step 4:

Choose your preferred main unit.

ClairiTech

INNOVATIONS

advanced clean air technology
technologie avancée de l'air pur

How to Choose Your Preferred Main Unit:

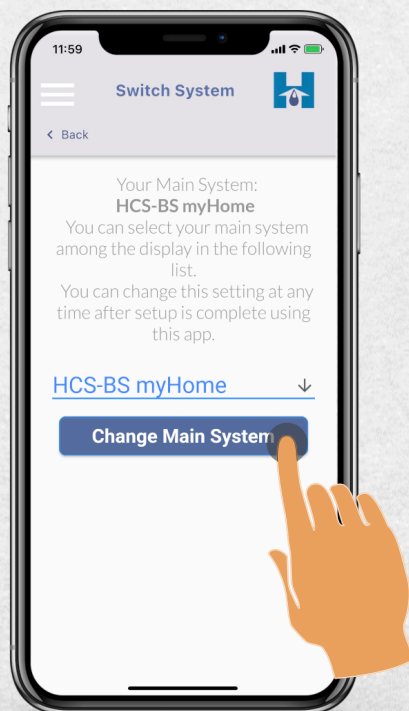

Step 5:

Once your preferred main unit is selected,

Tap “Change Main System”

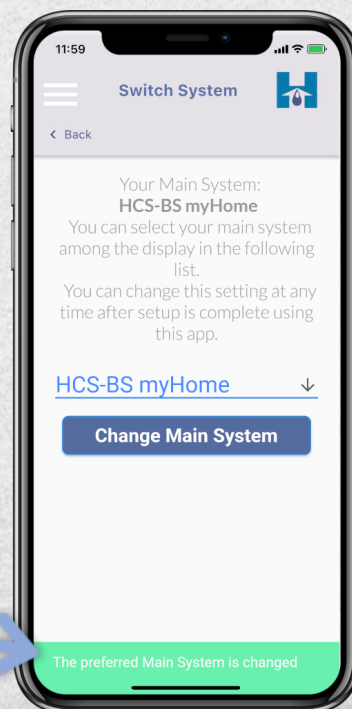

Step 6:

Your preferred main unit is successfully changed.

ClairiTech
INNOVATIONS

advanced clean air technology
technologie avancée de l'air pur



How to Contact Support :

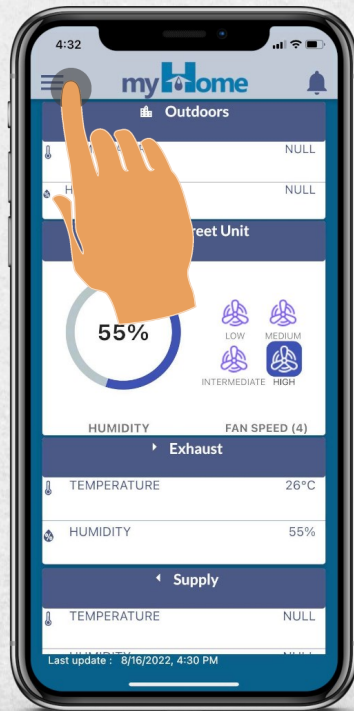

Step 1:

Tap the menu icon

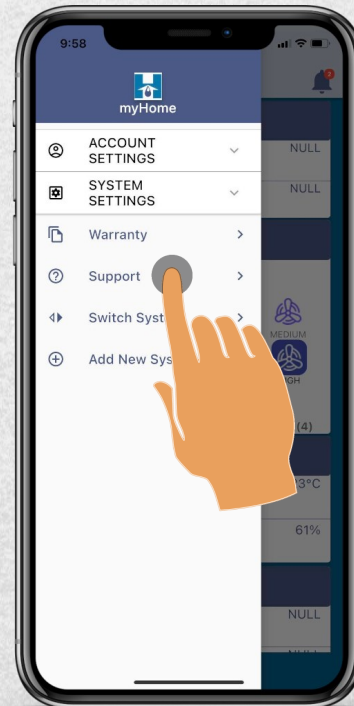

Step 2:

Tap “Support”

ClairiTech
INNOVATIONS

advanced clean air technology
technologie avancée de l'air pur

How to Contact Support:

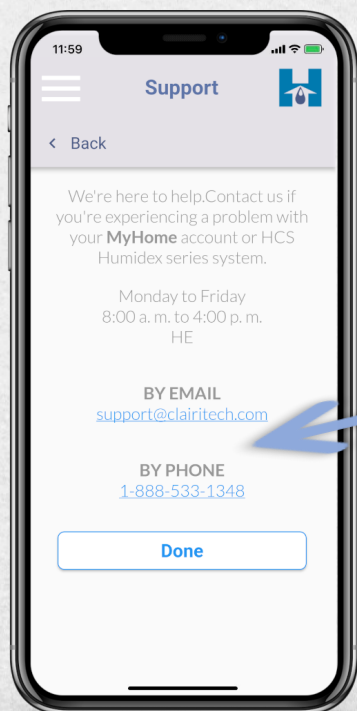

Step 3:

You may contact support
via email or phone

ClairiTech

INNOVATIONS

advanced clean air technology
technologie avancée de l'air pur

How to Go Back to the Dashboard from the Menu:

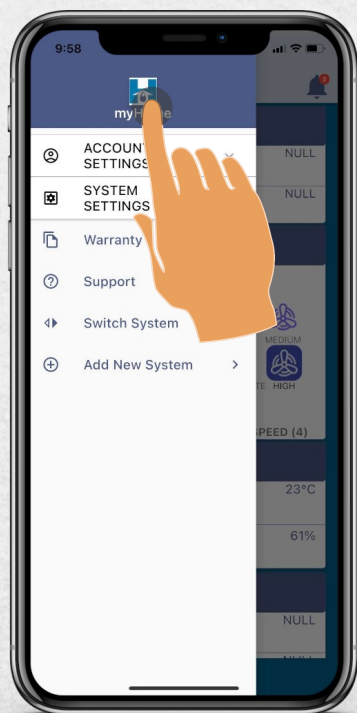

Step 1:
 Tap the myHome Logo

Step 2:
 The dashboard is displayed

